

POLE	2P	
A	NX5.08	10.16
B	(N-1)X5.08	5.08

- Technical Data:
- Material:
- Contact(metal housing): Brass Machined
 - Terminal screw: Steel galvanized and chromazite or Nickel plated or Tin plated (standard) (option)
 - Solder Pin: Brass with Tin plated
 - Insulator or body(housing): Polyamide(Glass filled)(UL94V-0)
- Electrical
- Voltage rating: 300VAC
 - Current rating: 20 Amps/way max
 - Contact resistance: 20m Ω (max)
 - Insulation resistance: 5000M Ω /1000V
 - Withstanding Voltage: 2000VAC(1min) Test time=60sec/1pcs
 - Wire Range: 12-30AWG
- Mechanical:
- Torque: 4kg-cm/M2.5
 - Operating temperature: -33°C to +120°C
 - Soldering ability: 95%coveragelmin
 - Test temperature= 250°C \pm 10°C
 - Test time= 4sec \pm 0.5sec
 - Soldering reliability: Test temperature= 250°C \pm 10°C
 - 5 seconds max

N=Number of contacts
P.C.B LAYOUT

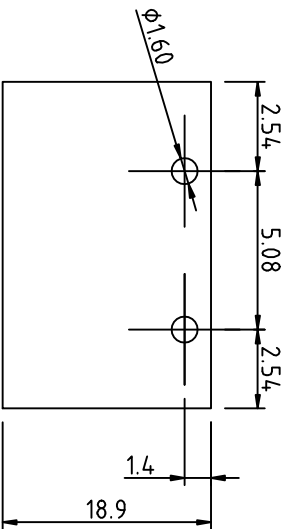

SIGN	DATE	DESCRIPTION	APPROVER
Δ			
Δ			
Δ			

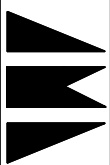

杰科电子有限公司
JIE KE ELECTRONICS CO., LTD.

PART NAME: JK129R-508 2P

TITLE:

PART NO.:

DWG NAME:

APPROVED BY

CHECKED BY

DESIGNED BY

DRAWN BY

CUSTOM NO.:

UNITS: mm

SCALE: 3/1

REVISION: B2

安杰

孙学丰



REVISION: B2

SCALE: 3/1

Tolerance
X. \pm 0.50
XX \pm 0.30
XXX \pm 0.10
X° \pm 1°